



M  R E L L A

... 1 & 2 BHK LUXURIOUS HOMES ...

... "YOU ARE NOT BUYING A HOUSE, YOU ARE BUYING A LIFESTYLE" ...

*a lifestyle...*





# MORELLA

••• 1 & 2 BHK LUXURIOUS HOMES •••

“

Proudly presenting **MORELLA** Located in Marunji - Hinjawadi, **MORELLA** is the new address for luxury and comfort. Offering you a choice of spacious 1 & 2 BHK homes, **Globe Properties** makes a new beginning in graceful living. Living is no longer restricted to a Bedroom, Hall and Kitchen. Presenting Super homes at **MORELLA**. The project offer a delightful mix of well planned apartments along with exciting amenities. The homes are adorned with branded fittings. Besides, you can experience comfort and convenience at all times. What's more, the connectivity to prime locations will make your life blissful. So book a super home at **MORELLA**, the destination of the future.

”







# MORELLA

... 1 & 2 BHK LUXURIOUS HOMES ...

“

Situated in a pleasant and peaceful locality, every home at **MORELLA** is designed to delight. Space optimizing layout, good ventilation, indoor fixtures that add a touch of luxury, excellent amenities and refreshing views from your window are some of the several highlights that make **MORELLA** stand out from the ordinary.

Get away from the stress and pollution of the city. Escape to a paradise - like place where you experience the vivid colours of nature. Transport your self to a magical world, where the tranquility and crisp air will help you relax, inside out. Indulge in hyper luxurious lifestyle , where top of the line amenities will fill your every moment with comfort and contentment.

”







# 1 BHK, 2 BHK

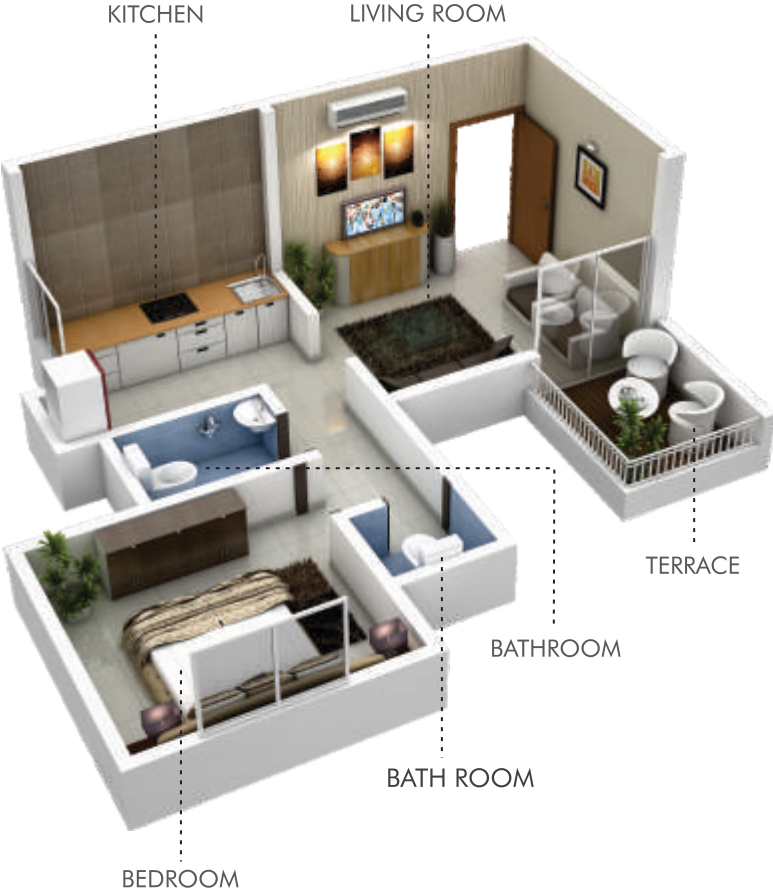



# EXTERNAL AMENITIES

- Attractive Entry Gate with Security Cabin
- Club House with indoor games
- Aesthetically paved / concrete outdoor area
- Performance stage
- Children's play area
- Senior citizen's sitting area
- Party Lawn
- Parking
- Branded lift with generator / solar / Inverter backup
- Generator / solar / Inverter backup for common areas







- Children's library
- Water softner plant
- CCTV for common areas
- Attractive lighting for common areas
- Rain Water Harwasting

- Fresh air and pollution free environment
- Natural lighting and ventilation for each flat
- Attractive elevation
- Best floor plan in marunji, 100% utilization of space

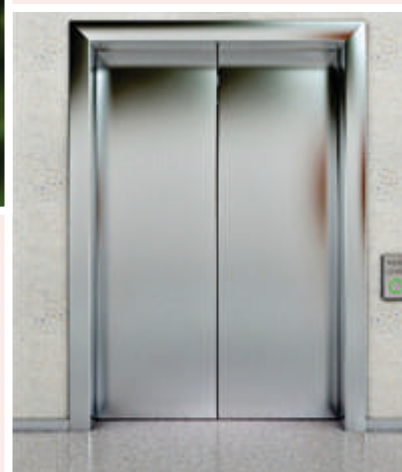



# INTERNAL AMENITIES

- Wooden tiles texture in bedroom
- Living room Fall Ceiling
- Safety door at the entrance of Flat
- Attractive Name Plate for each Flat
- Provision for internet with Wi-Fi
- Tool Kit at the time of Possession
- Mobile app at the time of Possession
- Exhaust fan for Kitchen
- Inverter Backup For Each Flat









# SPECIFICATIONS

- Black granite kitchen platform with “ss” sink
- Kitchen sink flexible with a hose (pull out kitchen faucet)
- Kitchen wall tiles upto ceiling
- Earthquake-resistant RCC structure
- 6” external brick work
- 6” / 4” internal brick work
- 2’ x 2’ vitrified flooring for the entire flat



- Ceiling fan in living rooms
- External sand - faced plaster
- Easy dry system
- Powder-coated aluminum sliding windows with safty grill and mosquito net
- Modular electric switches in all the rooms





- Ceramic tiles in bathrooms & terraces
- Jaguar / equivalent plumbing fitting
- Concealed electrical & plumbing
- Provision of hot water
- Inverter backup to each flat
- Multipurpose you-friendly tool kit

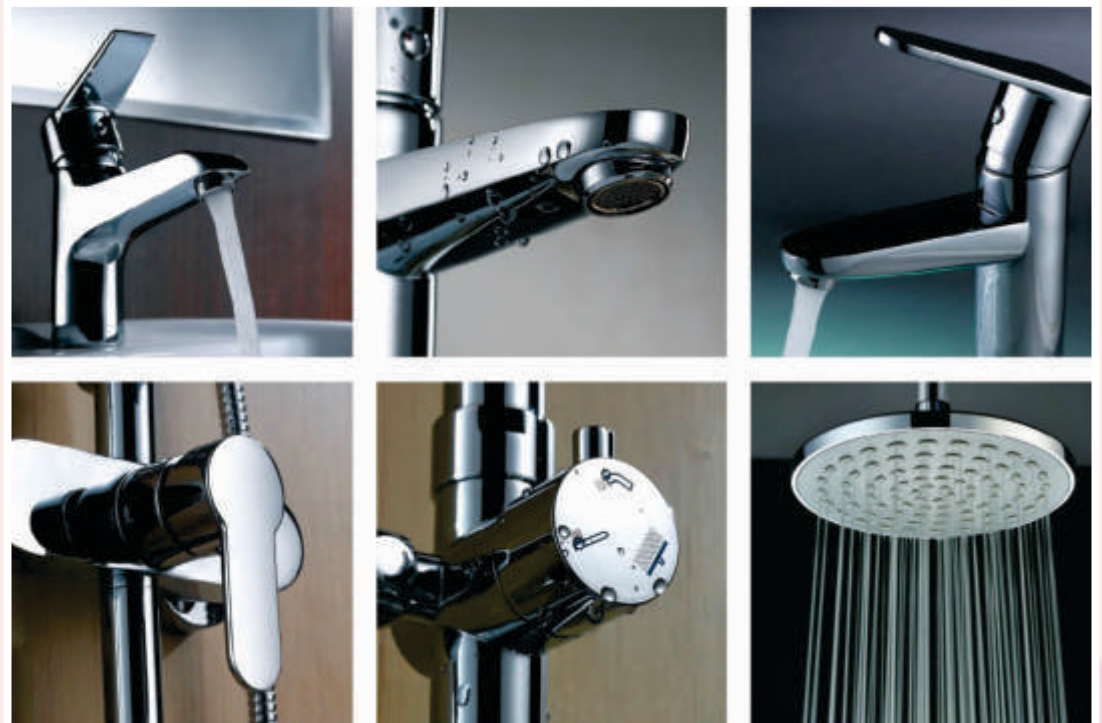

- Rain Water Harwasting
- Internal Sanla / Gypsum finish for common area with semi acrylic paint
- Both side lamination for main door with plywood door frame
- Internal wall finished Putty with Oil-bond distemper paint
- Flush door for bed room and water proof door for terrace and toilet



# KEY LOCATION



AIRPORT - 60min



SHOPPING COMPLEX - 5min



HOSPITALS - 5min



IT PARK - 5min



COLLEGE - 5min



SCHOOLS - 5min



FOOD MALL - 5min



HOTELS - 5min



BUS STOP - 5min



RAILWAY STATION - 15min



INFOSYS - 8min



PROPOSED METRO STATION - 5min



KPIT TECHNOLOGIES - 5min



WIPRO - 8min



IBM 5min



TCS ( tata consultancy services) - 10min



ATOS - 5min



# LOCATION MAP

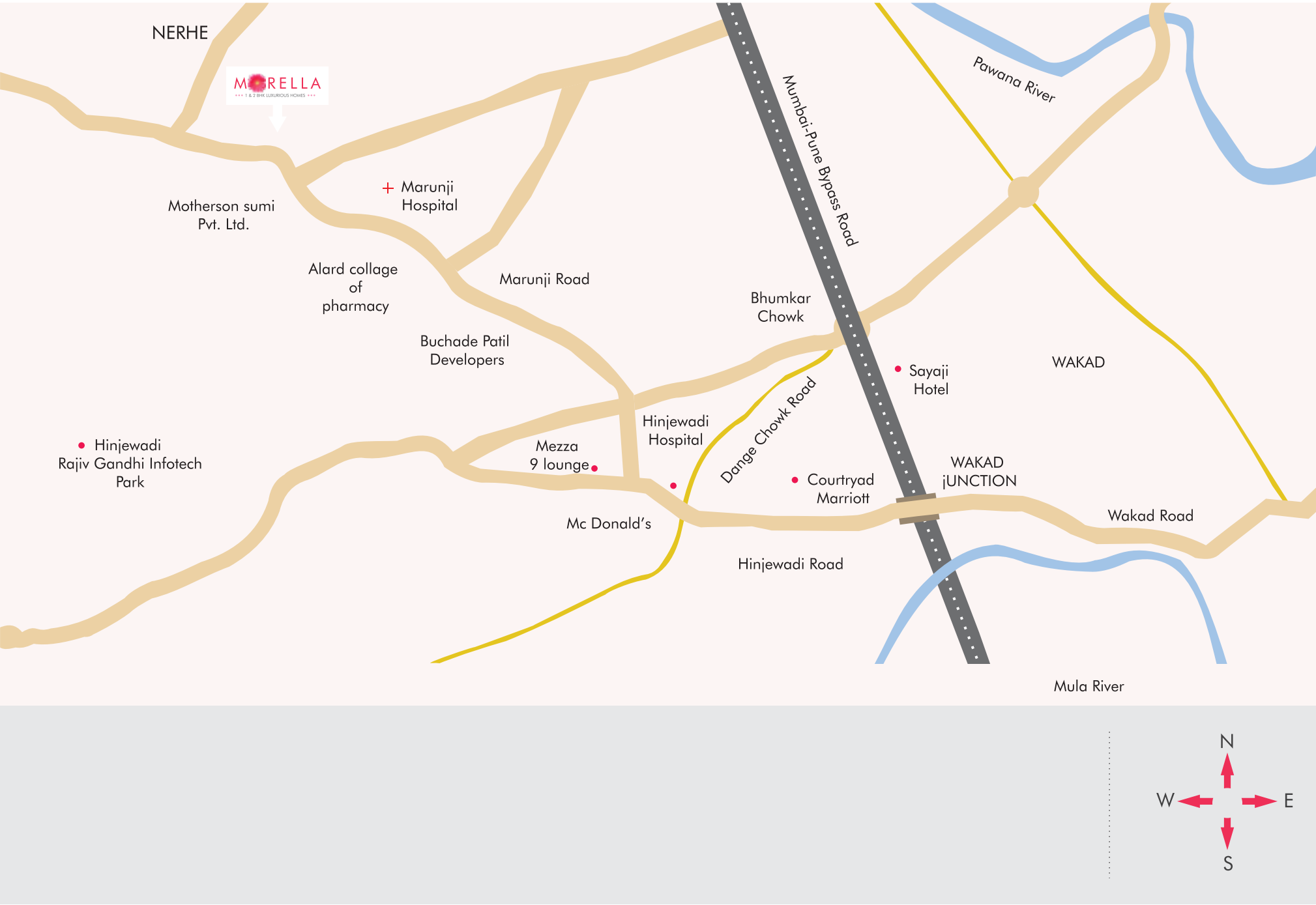



# MORELLA

... 1 & 2 BHK LUXURIOUS HOMES ...

Address : Morella SR No : 78/5 Next to Marunji Hospital, Marunji.  
Pune. 411057. Maharashtra, India,

Corporate Office : Buchade Patil Devolepers, SR No : 45/5 Shinde Nagar,  
Marunji. Pune. 411057. Maharashtra, India,

Contcat: +91 8975757501 | 8551030017

[sales@buchadepatildevolepers.com](mailto:sales@buchadepatildevolepers.com) | [www.buchadepatildevolepers.com](http://www.buchadepatildevolepers.com)

## ARCHITECT

Milind Panchal  
& Associates



## R.C.C

N.D. Jarag  
& Associates



## LEGAL ADV.

Amol V. Jadhav

A Project By :



P52100017772